



BROWNING[®]

TRAIL CAMERAS



MODEL BTC-5HD



PLEASE READ THIS MANUAL BEFORE USE

INSTRUCTION MANUAL



BROWNING[®]

TRAIL CAMERAS

Thank you for purchasing a Browning Trail Camera. Our trail cameras are constructed of the finest workmanship and materials available. As hunters ourselves, we have designed our products to help you get the most of your time in the field. We hope you enjoy scouting game for years to come with your new Browning Trail Camera.

Our customer service team is here to help you with any questions you may have operating or setting up your new trail camera. Our representatives are available Monday through Friday from 9am to 5pm CST.

Toll Free Customer Service: 1.888.618.4496

Customer Service email: service@browningtrailcams.com

QUICK START GUIDE

STEP 1

Press the battery tray eject button to release the battery tray. The tray will eject about 1/2". With a slight pull, the tray will completely eject.

Insert 6 AA Alkaline Batteries and an SD card into the camera.



STEP 2

Using the control pad, set the time and date.



STEP 3

Press the MODE button once. Camera will countdown a 30 second delay and then be ready to capture images.



TABLE OF CONTENTS

Package Contents	1
Batteries and SD cards	1
Camera Diagram	2
Battery Installation	3
Home Screen	4
Time and Date	5
Capture Mode	6
Photo Quality / Photo Delay	7
Multi-Shot / Rapid Fire	8
Video Settings	9
Camera Name / Temperature Units	10
Motion Test / Info Strip	11
Timelapse Settings	12
Default Settings	13
Delete Images	13
TV Out	13
Software Upgrade	13
Image Retrieval	14
Timelapse Viewer Software	15-17
Field Installation	18
Warranty	19
Accessories	20
FCC	21
Camera Specifications / SD card size chart	22

Getting Started

Package contents:

1- Trail Camera

1- 6' Tree Strap

1- Instruction Manual

1- Buck Watch Timelapse Mini CD

SD Card Selection

Install a good quality SDHC card. The best brands of SDHC cards are Browning branded cards, Sandisk or Kingston branded cards.

Please see page 22 for a graph showing how many photos, videos and timelapse segments can be stored on SDHC cards from 4-32GB. Based on your intended camera usage, this table will help you determine what size SDHC card you need to use in your camera.





Camera Diagram

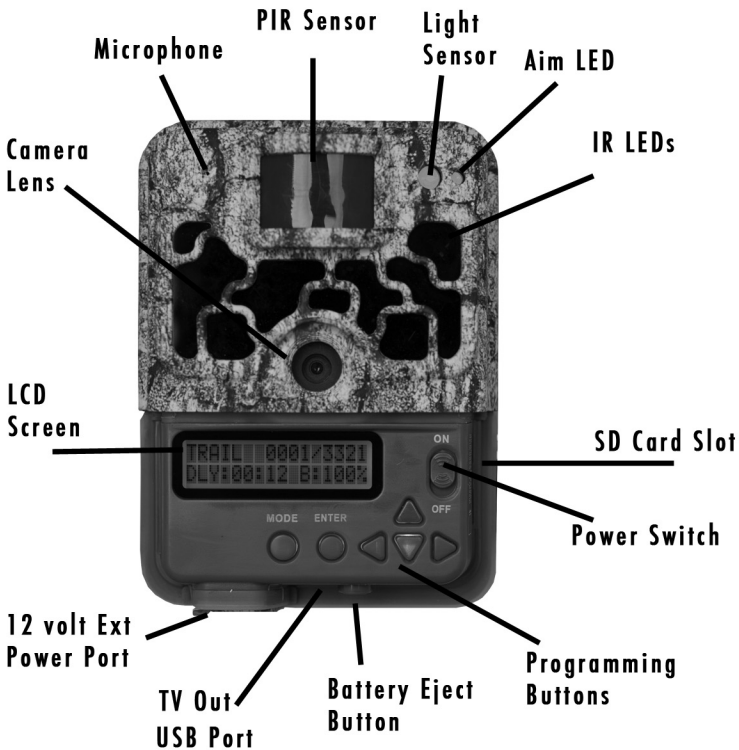



Battery Installation

Release the battery tray by sliding the Battery Eject switch. The battery tray will eject about 1/2". To completely remove the battery tray, simply pull the tray with a bit of force.

Install 6 AA Alkaline or Lithium batteries in the battery tray. Make sure you install the batteries with the correct polarity, following the markings on the battery tray. For optimal performance we recommend using Browning branded batteries, Energizer™ or Duracell™.

Slide the battery tray into the closed position.

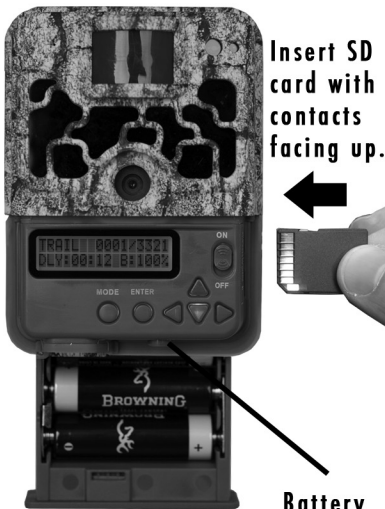

Insert SD card with contacts facing up.



Battery Eject Button



Home Screen

Turn the camera's power on by sliding the power switch to the ON position.



The home screen displays the camera operation mode, pictures or videos taken, pictures or videos possible on the SD card, camera delay countdown and battery life percentage. With home screen displayed, the camera is armed and ready to start taking pictures.

The possible camera modes displayed are Trail, Video and Timelapse Plus.

The delay countdown changes to RDY to indicate the camera is ready to take a picture.

The battery life meter shows the percentage of charge left in your batteries.

The battery indicator changes to EXT when an external battery is plugged into the external power port.



Set Time and Date

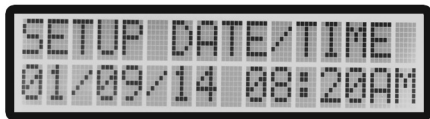

To Set the time and date:

From the HOME screen, press the MODE button once. This will take you to the SET TIME AND DATE screen.

Press the ENTER button once. The month selection will begin flashing. Use the UP and DOWN buttons to set the correct month.

When finished setting the month, press the RIGHT ARROW key to advance to set the correct day. Continue through all settings in this manner until the correct time and date appear.

Press the ENTER button once after you have made your selection for AM/PM. This will lock in your settings

Once finished, press the DOWN ARROW key to continue to the next camera setting option.



Capture Mode

CAPTURE MODE
TRAIL CAM

To set the camera's **CAPTURE MODE**, press the **ENTER** button once. The selection **TRAIL CAM** will begin to flash.

Using the **UP** or **DOWN** arrow keys, select the operation mode for your camera. Press the **ENTER** key when finished.
CAPTURE MODE OPTIONS:

- **TRAIL CAM** This setting will take still pictures of game during the day and night, when motion is detected. This is the most popular setting for trail camera use. If you are new to trail cameras, this is the best setting to use.
- **VIDEO MODE** This setting will take HD video clips of game during the day and night..
- **TIMELAPSE PLUS** Timelapse Plus mode takes pictures during the day at pre set intervals, which is good for scouting a large open field where you are not sure where game is travelling. In addition, your camera will also take motion activated pictures as well during the day and night to make sure you do not miss any game activity.

To continue and set the camera's **PHOTO QUALITY**, press the down arrow once.

Photo Quality

PHOTO QUALITY
HIGH

To set the PHOTO QUALITY, press the ENTER button once. The selection will begin flashing. Use the UP and DOWN arrow keys to make your selection.

OPTIONS:

-LOW 2 MP

-MED 4 MP

-HIGH 8 MP

-ULTRA 10 MP

Press ENTER button to save. Press the DOWN arrow to proceed to the PHOTO DELAY settings.

Photo Delay

PHOTO DELAY
1 MIN

To set PHOTO DELAY, press the ENTER button once. The selection will begin flashing. Use the UP and DOWN arrow keys to make your selection.

DELAY OPTIONS:

5, 10, 20, 30 seconds

1, 5, 10, 30, 60 minutes.

Press the ENTER button to save selection.

The PHOTO DELAY option allows you to choose how much of a "timeout" there is between taking still pictures or videos. Press the DOWN arrow to proceed to set MULTI SHOT mode.





Multi Shot Modes

MULTI-SHOT
OFF

To program the **MULTI SHOT** mode, press the **ENTER** button once. The selection field will begin to flash. Make your selection using the **UP** and **DOWN** arrows. Press the **ENTER** button to save your selection.

Your Browning Trail Camera can take multiple shots each time the camera is triggered. The default setting is 1 picture. Your options are as follows:

-MULTI SHOT OFF This is the default setting. Your camera will only take 1 picture when triggered.

-MULTI SHOT STANDARD The selections available are 1-8 shots in this mode. If you select **4-SHOT STANDARD**, your camera will take 4 pictures, spaced 2 seconds apart.

-RAPID FIRE This selection allows rapid image capture. When triggered, your camera will take 2-8 **RAPID FIRE** shots, with only 0.3 seconds between pictures. Your available options are 2,3,4,5,6,7, or 8 **RAPID FIRE** shots.

Press the **DOWN** arrow button to proceed to the video settings.

Video Settings

To change your video settings, press the ENTER button once to make the default selection flash. Use the UP and DOWN arrows to change selections. Press the ENTER button to save the changes.



VIDEO RESOLUTION
HIGH

VIDEO RESOLUTION

Both video settings capture in 1280 x 720 resolution. The difference between ULTRA and HIGH video settings is the amount of compression used when saving the video file. The ULTRA setting uses less compression when saving the file. This allows for a higher quality video, but the file size will be large.



VIDEO LENGTH
5 SECS

VIDEO LENGTH

You can select the length of your video clip as well in the VIDEO LENGTH window. Your options are: 5, 10, 20, 30 seconds, 1 minute or 2 minute lengths.

NOTES:

To conserve battery power, your night videos are limited to a maximum time of 10 seconds. For example, if your video length is set at 30 seconds, your camera will take 30 second videos during the day, and your night videos will be limited to 10 seconds.

Press the DOWN arrow once to proceed to the camera name setting.





Camera Name

CAMERA NAME
CAMERA1

You can add a custom name for your camera if needed. To name your camera, Press the **ENTER** button once. This will highlight the first character in the camera name. Use the **UP** and **DOWN** arrows to change the field. Press the **RIGHT ARROW** button to move to the next letter. Your available characters are Capital A-Z, 0-9 or a blank space. When finished, press the **ENTER** key to save your selection. Press the **DOWN** button to proceed to the setting for temperature units.

Temperature Units

TEMPERATURE
FAHRENHEIT

Your temperature units can be displayed on the picture's info bar in Fahrenheit or Celsius. To change the selection, Press the **ENTER** button once, and then use the **UP** and **DOWN** arrows to make your selection. Press **ENTER** to save your selection. Press the the **DOWN** button to proceed to the next setting.

Motion Test



MOTION TEST
OFF

Your trail camera is equipped with a MOTION TEST feature. This feature helps you aim the camera at your target area. With the motion test turned on, simply walk around in your target area. When your presence is detected, a red LED on the front of the camera will flash.

Simply press the ENTER button, the selection will flash. Use the UP and DOWN arrows to change the option. Press the ENTER button to confirm selection.

Make sure you turn OFF the MOTION TEST function before leaving the camera in the field.

Press the DOWN arrow to proceed to the info strip setting.

Info Strip



INFO STRIP
ON

Your trail camera has an information bar that is printed at the bottom of each photo taken. This info strip shows the following information: time, date, moonphase, temperature, and camera ID. This option can be turned on or off, using the UP and DOWN arrow buttons.

Press the DOWN button to proceed to the timelapse settings.





Timelapse Settings

Your Browning Trail Camera has the ability to function as a timelapse camera. This is useful if you want to view the entire activity in a given area such as a large field. We recommend you use the TRAIL CAM mode for game when watching trails and feeding areas.

TIMELAPSE FREQ
15 SECONDS

TIMELAPSE FREQUENCY

Your trail camera can be set to take timelapse pictures at the following frequencies: 5, 10, 15, 30, 60 seconds; 1, 2, 5, 10 30 and 60 minutes.

TIMELAPSE DUR
3 HOUR

TIMELAPSE DURATION

The timelapse duration controls how many hours per day the camera captures timelapse images. Your available TIMELAPSE DURATION options are:

- ALL DAY Camera takes images from sunrise to sunset.
- 2, 3 or 4 HOUR These Durations limit the camera from taking images either 2, 3 or 4 hours after sunrise and 2,3 or 4 hours prior to sunset.

NOTE: Your trail camera learns the length of a day and constantly adjusts the 2,3 or 4 hour duration modes automatically.

Press the DOWN button to advance to the next camera menu option.

The following options can be changed by pressing the ENTER button to highlight the option, and changing the selection using the UP and DOWN arrows. Remember to press the ENTER button to save your selection. Press the DOWN button to move to each new option to set below.

Default Settings

This selection returns your camera back to the factory default selections for each setting.

Delete All

By selecting DELETE ALL, all of the images on your SD card are erased. This function also reformats your SD card. It is a good idea to use the DELETE ALL function and reformat your SD card each time you install it in the camera for use.

TV Out

The TV Out selection allows you to adjust the TV signal output from the camera between NTSC or PAL. If you are using this product in the US or Canada, the NTSC setting should be used. The PAL setting is for TV sets in Europe and Asia.

Software Upgrade

The software upgrade function allows you to upgrade your software. If a software upgrade is available for your camera, it will be posted on our website, along with detailed instructions for upgrading at:
www.browningtrailcameras.com/customer-service





Image Retrieval

The most popular way to review the images on your SD card is to review the images on your home computer. The pictures can be viewed on both PC and Mac computers.

Simply insert the SD card into the SD card slot on your desktop or laptop computer. If your computer does not have an SD card slot, you will need an SD card reader. These are inexpensive and can be found at your local sporting goods or electronics store.

After your SD card is inserted into your computer, navigate to **START/MY COMPUTER/**. Look for the SD card icon.

Double click on the SD card icon. A folder named **DCIM** will appear. Double click on the **DCIM** folder. A new folder appears with called **100_BTCF**. Your pictures are in this folder.

You can also connect your trail camera to your computer via a USB cable (not included). In this case, your camera becomes the SD card reader. Follow the instructions above to locate your picture files.

The SD images on the SD cards can be viewed using the USB connection with any PC running Microsoft Windows XP or later versions, or a Mac running OSX or later versions.

Timelapse Viewer Installation

In order to playback your timelapse video files, you need to install the Browning Buck Watch Timelapse Viewer software. This software will work on any PC running Windows XP, Vista, 7. Simply insert the mini CD ROM included with your camera into your CD drive and follow the onscreen installation instructions.

IMPORTANT: Once you have loaded the Buck Watch viewer on your computer, a full set of operation instructions is available by clicking on the HELP icon in the viewer window.

If your CD is lost or missing, you can download a free copy of the Buck Watch software from our website at www.browningtrailcameras.com/customer-service





Timelapse Viewer



The Browning Buck Watch Timelapse Viewer is a powerful tool to help manage game on your property. You can easily playback an entire days worth of timelapse imagery in only a few minutes, as well as view each image one-by-one if desired. For a quick look at long video files, you can also use the "Activity Search" function to allow the software to skip frames with no game activity, and stop only on frames where game or movement is present.

Timelapse Viewer



Timelapse Viewer controls:



Open a file of still pictures to play in viewer



Open a timelapse file for viewing



Rewind, Pause, Play Controls



Activity Search Controls



Change Viewer Settings Control



Zoom In, Zoom Out Controls



Image Advance Controls



Save and Share Still Images or Export Video Clips



Field Installation



- We recommend mounting your new trail camera at a height of approximately 3 feet off the ground.
- The heavy duty 1" nylon strap threads through the strap mounting loops in the back of the camera and will secure your trail camera to trees large or small.
- For optimal trail camera mounting, we recommend using the Browning Trail Camera Tree Mount. This mount has a locking gimbal that can position your trail camera at the optimal angle.
- The back of your trail camera is also equipped with built in security cable loops. These are perfect for using a locking steel cable or a 5/16" Python™ cable lock (not included).



ONE YEAR LIMITED WARRANTY

Your Browning Trail Camera warranty covers your trail camera for one year. We warrant that your camera will be free from defects in workmanship and materials when operated in normal use and conditions. This warranty will allow Browning Trail Cameras, at its discretion, to repair the product or replace it with a new or refurbished unit.

Warranty limitations:

This warranty does not cover cameras that have been:

1. Neglected or abused (including, but not limited to water damage caused by submersion, battery leakage, or improper storage).
2. Modifications or repairs by unauthorized agents.
3. Damaged cameras that have cracked or broken outer cases due to excessive impact, heat or mishandling.
4. Damages caused by wild animals.

WARRANTY SERVICE

In the event warranty service is needed, contact Browning Trail Camera's customer service at 1.888.618.4496. Our knowledgeable agents can help troubleshoot any issues with your trail camera. In the event your camera needs to be returned for service, our agents will advise the correct mailing address and RMA number needed for proper service of your unit. You will also need your original receipt, or proof of purchase for warranty service. You are responsible for packaging and shipping cost of your camera unit to our warranty center.



Accessories

We offer a full line of accessories for use with your new Browning Trail Camera.

AA BATTERIES



STEEL SECURITY BOXES



SD CARDS



TREE MOUNTS





This device complies with Part 15 of the FCC Rules. Operation is subject to the following two conditions: (1) this device may not cause harmful interference, and (2) this device must accept any interference received, including interference that may cause undesired operation.

This equipment has been tested and found to comply with the limits for a Class B digital device, pursuant to part 15 of the FCC Rules. These limits are designed to provide reasonable protection against harmful interference in a residential installation. This equipment generates, uses and can radiate radio frequency energy and, if not installed and used in accordance with the instructions, may cause harmful interference to radio communications. However, there is no guarantee that interference will not occur in a particular installation. If this equipment does cause harmful interference to radio or television reception, which can be determined by turning the equipment off and on, the user is encouraged to try to correct the interference by one or more of the following measures:

- Reorient or relocate the receiving antenna.
- Increase the separation between the equipment and receiver.
- Connect the equipment into an outlet on a circuit different from that to which the receiver is connected.
- Consult the dealer or an experienced radio/TV technician for help.

Shielded cables with ferrite must be used with this unit to ensure compliance with the Class B FCC limits.

Warning: Changes or modifications to this unit not expressly approved by the party responsible for compliance could void the user's authority to operate the equipment.

Camera Specifications

PHOTOS	YES	Effective Pixels	1920x1080
Ultra	10MP	Removable Memory	32 GB
High	8 MP	Trigger Time	0.67 Seconds
Medium	4 MP	Field of View	55 degrees
Low	2 MP	Shooting Modes	Still, Video, Timelapse Plus
VIDEOS	YES	Battery Requirements	6 AA Alkaline or Lithium cells
High	1280 x 720 Low Compression	Mounting	1" nylon strap 6" long
Low	1280 x 720 High Compression	Aux. Power Input	12 V
Length	5, 10, 20, 30 sec. 2, 5 min.	IR Detection	55 ft. Average
Sound	YES	IR Flash Illumination	100 Ft.
TIMELAPSE	YES	Certifications	FCC, CE
Modes	Timelapse plus IR triggered pictures	Info printed on Picture	time, date, moonphase,temp, Cam ID
		Timelapse Delays	5, 10, 15, 30, 60 sec., 1, 2, 5, 10, 30, 60 min.

SD card selection

Number of pictures, videos or timelapse segments that can be stored on each size SD card. Actual picture counts may vary.

	4 GB	8 GB	16GB	32GB
PHOTOS				
10MP	1497	2980	5990	12250
4MP	3744	7488	14976	29952
2MP	7480	14960	29920	59840
1.3 MP	12288	24576	49152	98304
VIDEOS				
ULTRA RES				
10 Sec.	85	180	360	720
HIGH RES				
10 sec.	110	230	460	920
TIMELAPSE				
All Day	8	16	32	64
(number of 8 Hour segments shooting on a 15 sec delay)				



BROWNING[®]

TRAIL CAMERAS



SUB MICRO SERIES

Manufactured and Distributed by:

Prometheus Group, LLC P.O. Box 130100

Birmingham, Alabama 35213-0100

1-888-618-4496

© Prometheus Group, LLC

Browning trademarks licensed from Browning